







This supplementary instruction manual contains only the steps specific to the LAZER ZX-RR assembly. Use it together with the LAZER ZX-R instruction manual.

1 • The shocks changed. Use Bag No.1,3,6

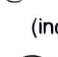
- | | |
|--|--|
| <p>16 E-ring 8</p>  | <p>163 3×7×2mm Collar 8</p>  |
| <p>159 O-ring (Blue) 8</p>  | <p>154 3×6×3mm Collar (incl. with front hubs) 2</p>  |
| <p>160 3×6×2mm Collar 4</p>  | <p>161 3×7×1mm Collar 4</p>  |
| <p>162 C-ring 4</p>  | <p>20 5.8mm Ball 8</p>  |

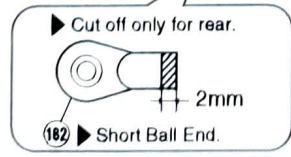
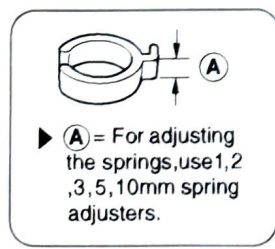
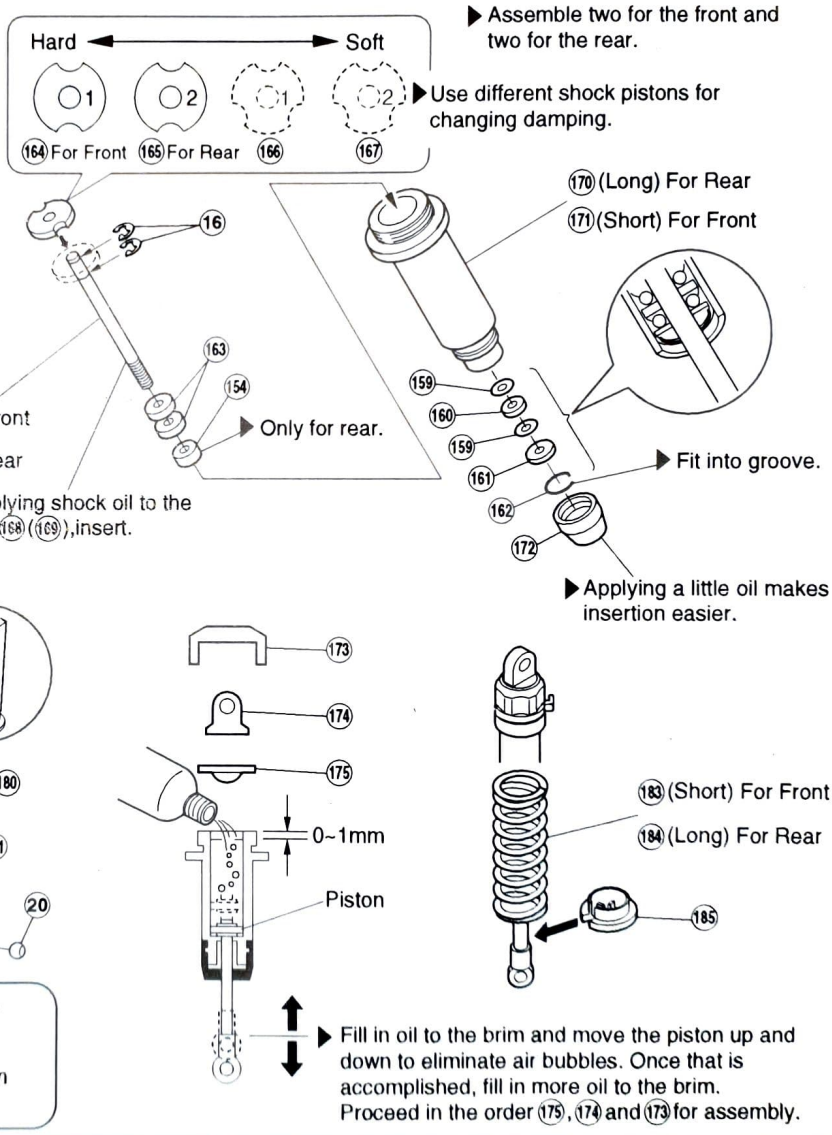

2 • Assemble the control rods. as shown below. Use Bag No.3

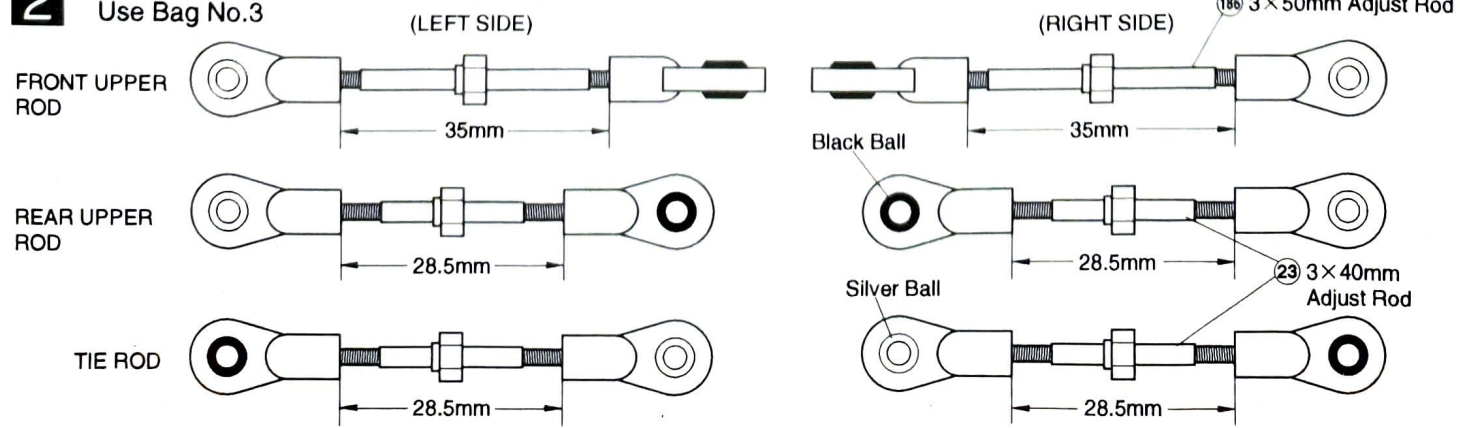

- 3** • Trim the gear cover as shown.
Use Bag No.4

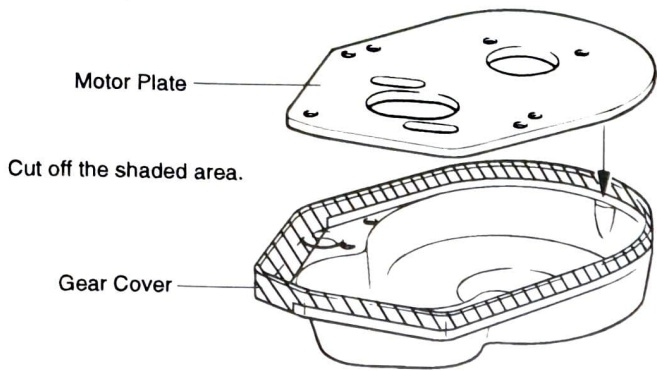

- 4** • Instead of 3mm nuts, tapered washers are used.
Use Bag No.3

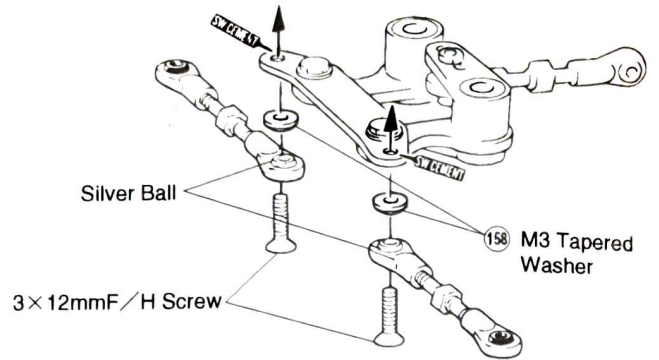

- 5** Use Bag No.4

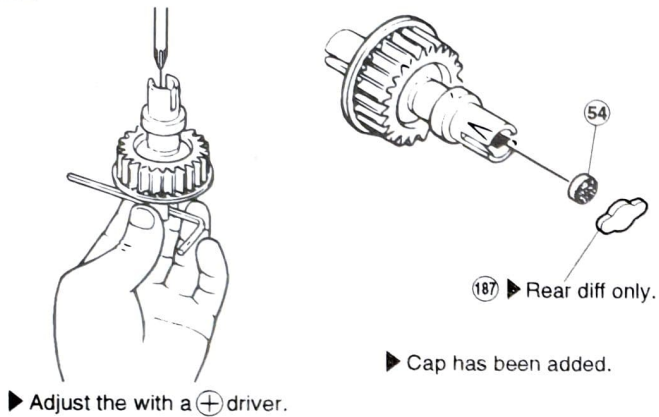

- 7** • The slipper clutch changed.
Use Bag No.4

1

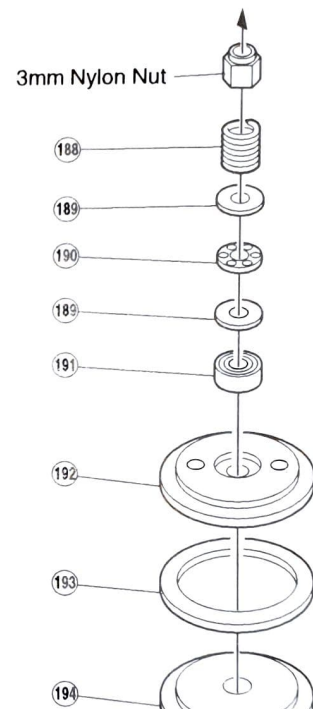

▶ First, install (148).

▶ Slide (196) up to (148) and tighten set screw to the flat spot.

3 x 3mm Set Screw

2

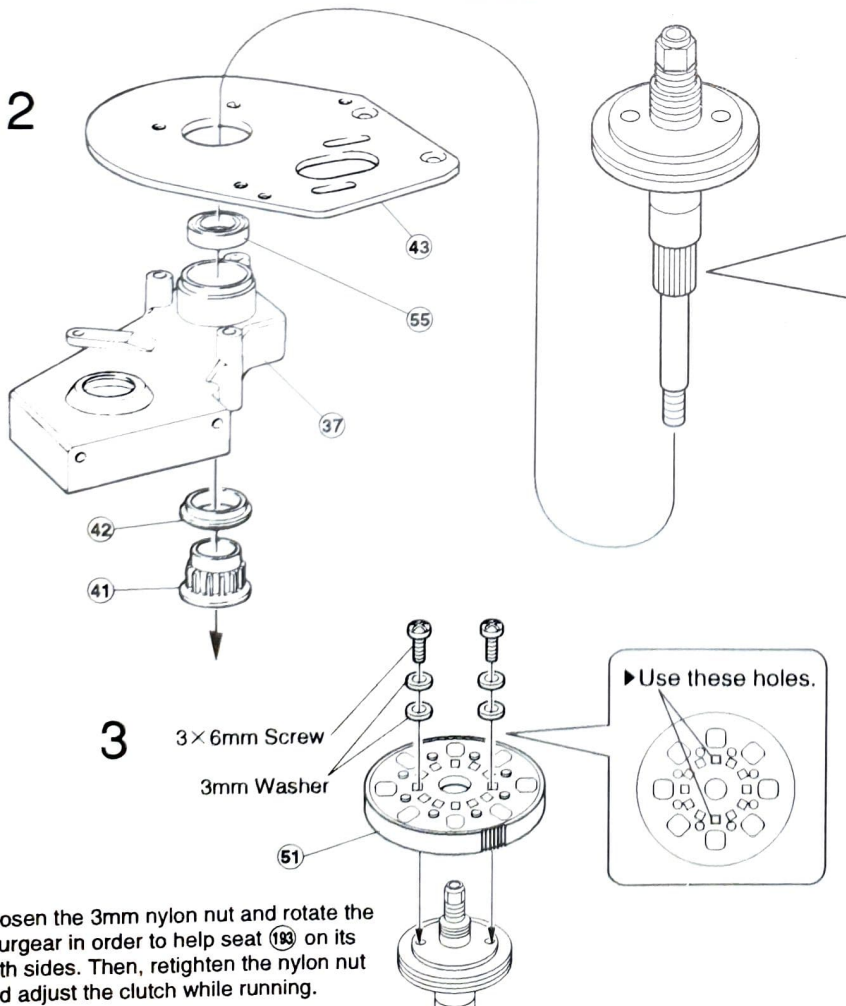

3

3 x 6mm Screw
3mm Washer

▶ Loosen the 3mm nylon nut and rotate the spur gear in order to help seat (193) on its both sides. Then, retighten the nylon nut and adjust the clutch while running.

8 • Instead of ①④⑥ 4×6mm shim, ①⑨⑦ is used. Use Bag No.4

• ④⑥ Side plate (L) changed in shape.

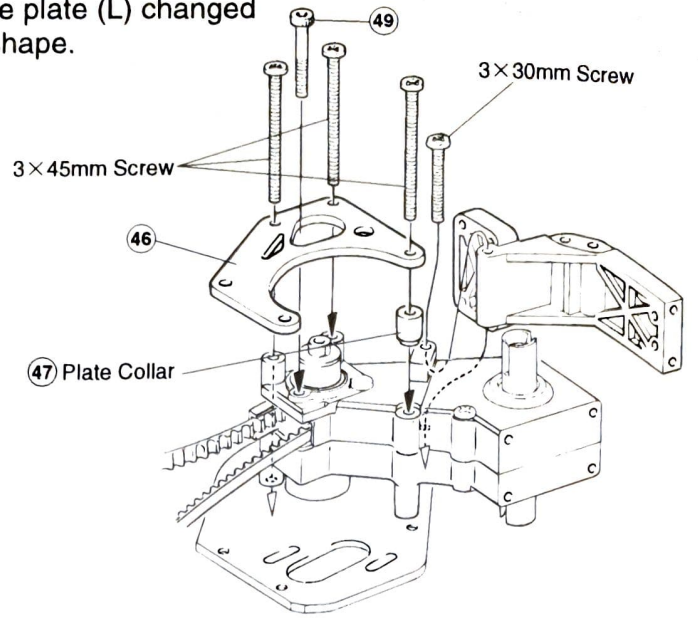
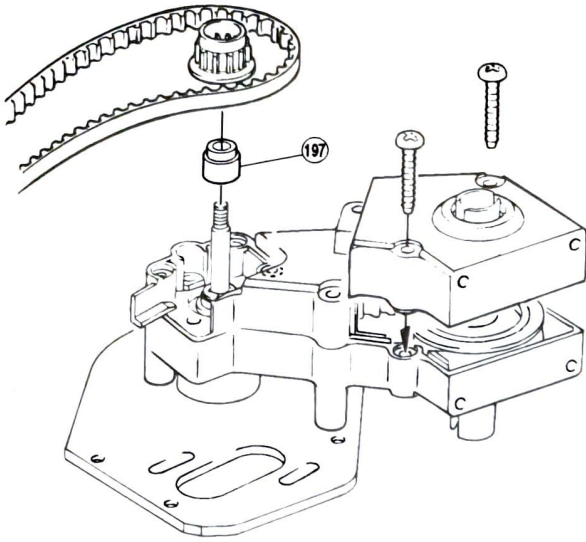

9 • The chassis is designed to hold a 7.2V Ni-Cd battery so the ②⑤ Upper Deck Post is not used.

10 • The ball diffs changed in structure.

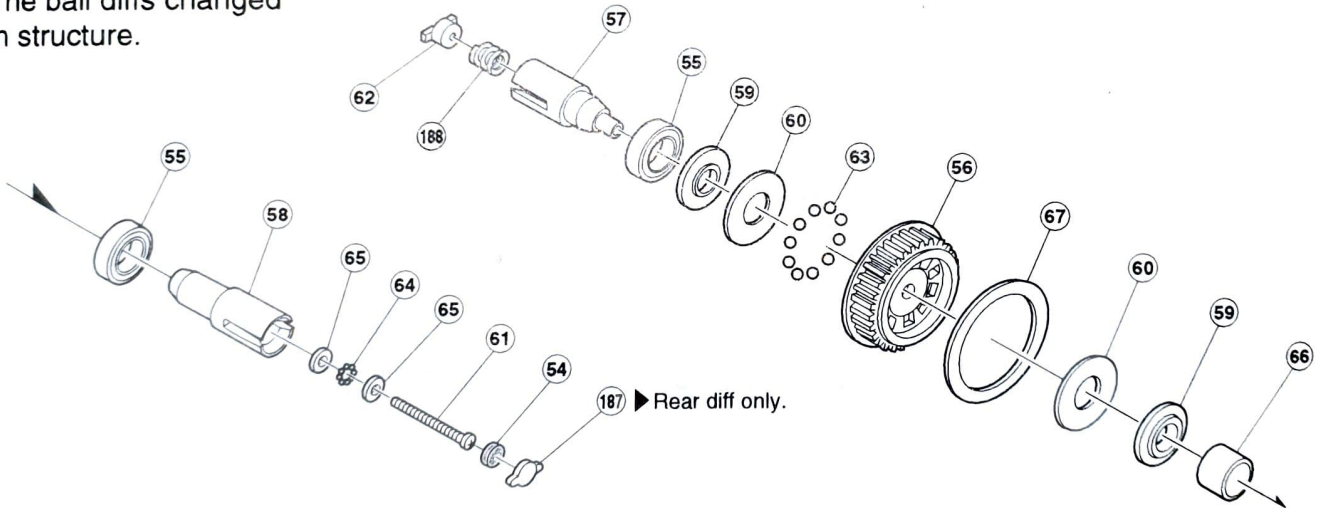

11 • The stopper posts changed. • Attaching ④⑥ changed. Use Bag No.6

①⑩② Stopper Washer

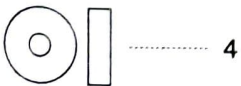

▶ Attach the stopper plates in ②③ with hook pins.

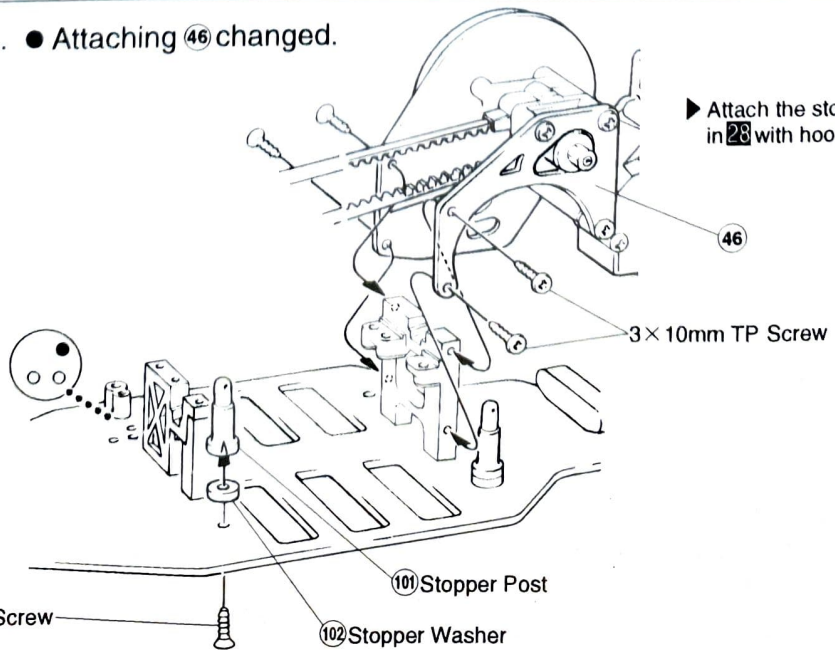

12 • The front shock stay changed in shape.
Use Bag No.3,5

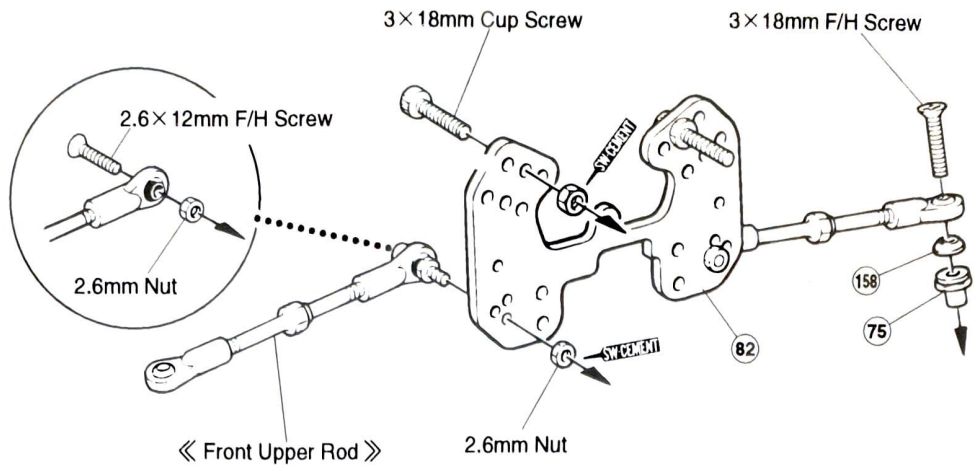
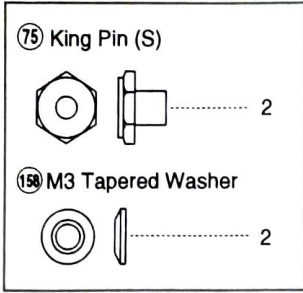

13 • Attaching the knuckle arms changed.
Use Bag No.5,6

► "R" = left.
"L" = right.

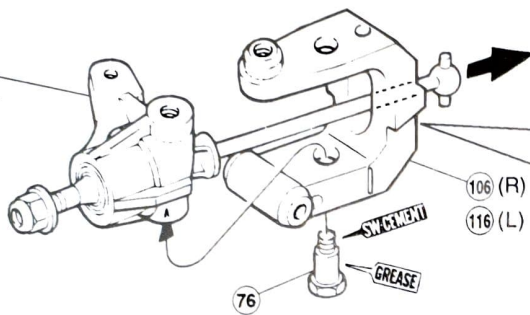

► Note the direction.

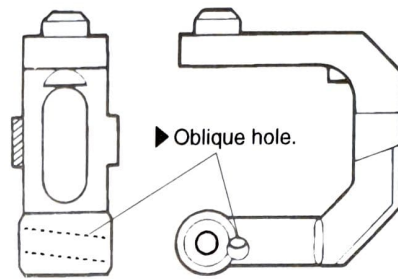

► Cut off the shaded portion.

14 • Attaching the suspension arms changed.

► Hole for passing through hub pin.

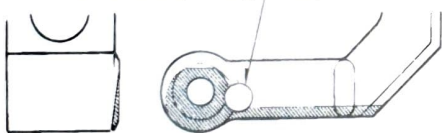

► Trim off the shaded portion.

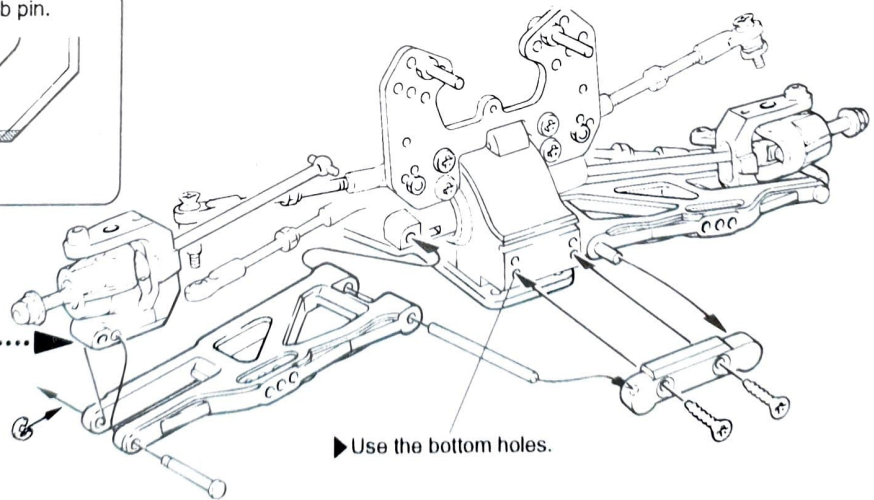

15 • Hole for installing the upper rods changed.

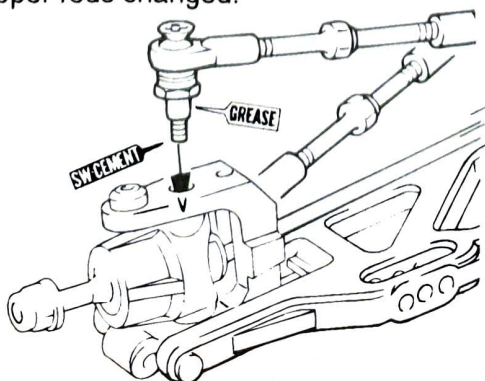

16 • The rear shock stay changed in shape.

• Trim the wing stay (B) as shown.

▶ Install 3×18mm Cap Screws to holes (A).

▶ Install the Rear Upper Rods to holes (B).

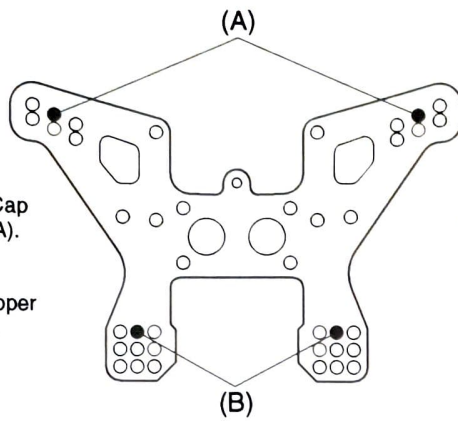

▶ Cut off the shaded portion.

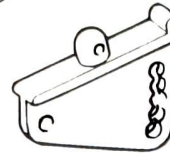

17 • Rear hub plates have been added.

198 Rear Hub Plate (L)
199 (R)

▶ Hole for attaching the rear upper rod (see 18).

3×10mm TP F/H Screw

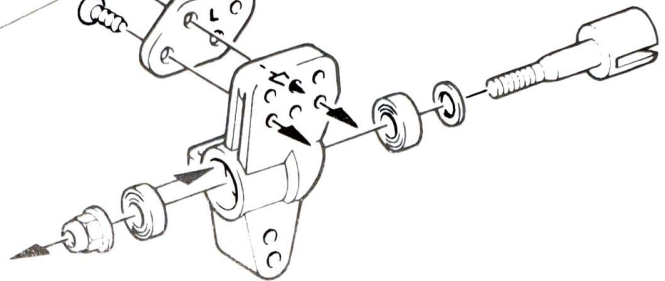

20 • Attaching the motor changed.
Use Bag No.8

▶ Make 3mm hole.

153 Motor Spacer

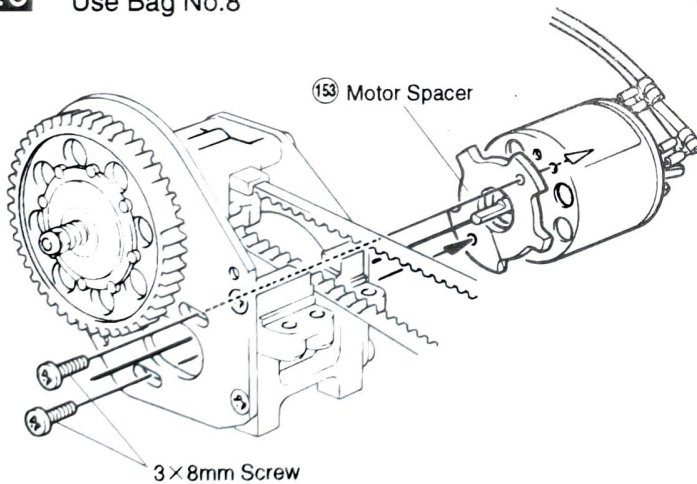

3×8mm Screw

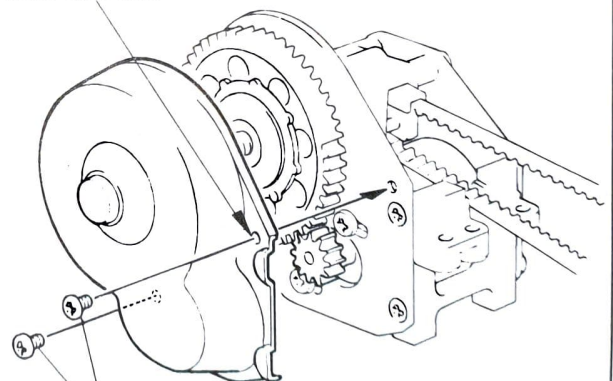

3×4mm Screw

29 • Attach the shock's upper end as shown.
Use Bag No.1

200 Shock Collar

201 Plastic Nut

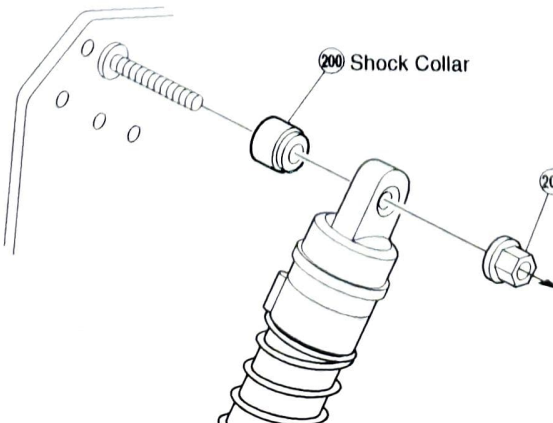

30 ● Inner sponges have been added.
Use Bag No.8

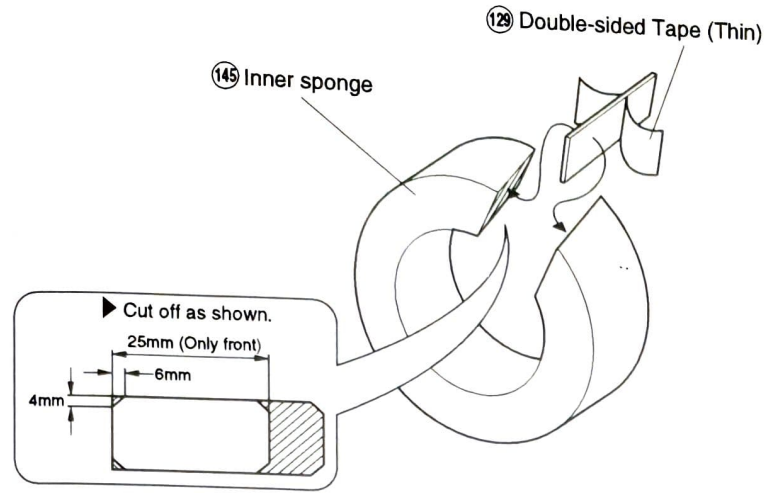

▶ Clean the tires with a neutral detergent.
Roughen the tires where glued onto the wheels.

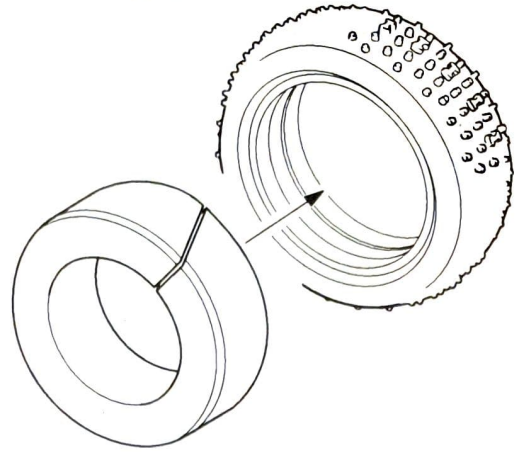

32 ● The wing and the side wings are one piece.

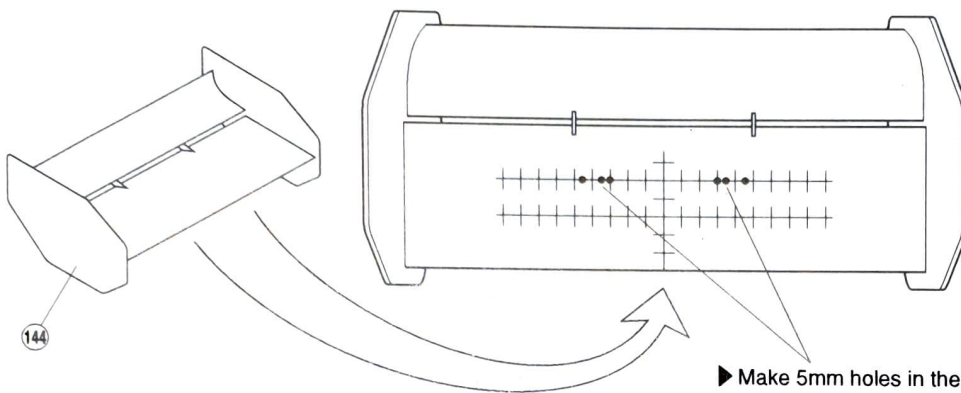

Page 25 PURCHASABLE PARTS FOR YOUR KIT.

● The following parts have been added to each LAZER ZX-RR kit.

NO.	Part Names	Description
LA-4	Diff Ball	63 x15
LA-28	Rear Hub Carrier	104 105 198 199 x1
LA-59	Front Hub Carrier (+7°)	106 116 x1 154 x2
LA-60	Main Chassis (ZX-R)	139 x1
LA-61	Upper Deck (ZX-R)	132 x1
LA-62	Motor Plate Set (ZX-R)	43 46 47 x1
LA-63	King Pin Set (ZX-R)	75 x2
LAW-12	Hyper Clutch Set	148 188 190 191 192 193 194 195 196 197 x1 189 x2
OT-73	Motor Cleaner Set	153 x1
OTW-9	Plastic Parts Set	101 102 x4
OTW-13	Adjust Rod (L)	186 x2
W-0141	M3 Taper Washer	158 x10
W-5013M	Spring Set (M)	183 x2 (5types)
W-5013L	Spring Set (L)	184 x2 (5types)
W-5038	Inner Sponge	129 x1 145 x2
W-5063	Universal Swingshaft (3L)	85 x2
39371W	Rear Wing (White)	144 x1

NO.	Part Names	Description
W-5098	Ultimate Shocks (M)	160 161 162 164 165 166 167 168 170 172 173 174 175 176 177 178 179 180 181 182 185 200 201 x2 16 20 159 163 x4
W-5099	Ultimate Shocks (L)	160 161 162 164 165 166 167 169 171 172 173 174 175 176 177 178 179 180 181 182 185 200 201 x2 16 20 159 163 x4
W-5601	High-traction Tire Narrow (56 size, H-pin)	140 x2
W-5602	High-traction Tire (56 size, H-pin)	141 x2
WBD-4	Pressure Plate	60 x2
WBD-5	Ball Diff Shaft Set	54 57 58 61 62 66 187 188 x1 59 65 x2 64 x10
WBD-6	Ball Diff Thrust Set	54 61 187 x1 65 x2 64 x10
WBD-7	Adjust Spring	188 x2
SST-9	Slipper Plate	193 x1
H-3051	3mm Thrust Bearing	190 x2 189 x4
39314	Special Ball Diff Grease	x1

● The following parts are not required for assembling the LAZER ZX-RR.

LA-16 LA-18 LA-19 LA-27 LA-39 LA-55 LA-56 LA-57 LAW-3 OT-4 TM-4 TM-12 TM-19 TM-28 TM-30
W-5000 W-5002 W-5061 W-5631M W-5641M W-5036 W-5016 W-5017 W-5018 WBD-1 WBD-2 1877